

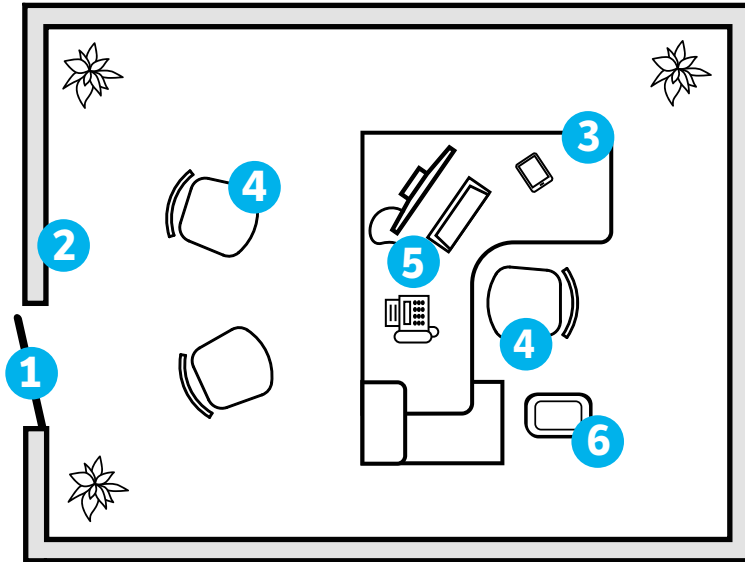





# ADMINISTRATIVE

Protect customers and staff members from left-behind germs in common areas. Keep everything clean by properly cleaning, sanitizing, and disinfecting these commonly-touched surfaces.



## Key Touchpoints for cleaning include:

- 1  Door handles
- 2  Light switches
- 3  Desks
- 4  Chairs
- 5  Electronics (computers, phones, etc.)
- 6  Trash/recycling receptacle

**Bright** the smart way to clean!  
**Solutions.**

find us at [mybrightsolutions.com](http://mybrightsolutions.com) and on  and 