

# RESIDENT ROOM/BATHROOM

Some of the most germ-ridden touchpoints are in resident rooms and bathrooms. Keep everything clean by properly cleaning and disinfecting these commonly-touched surfaces.

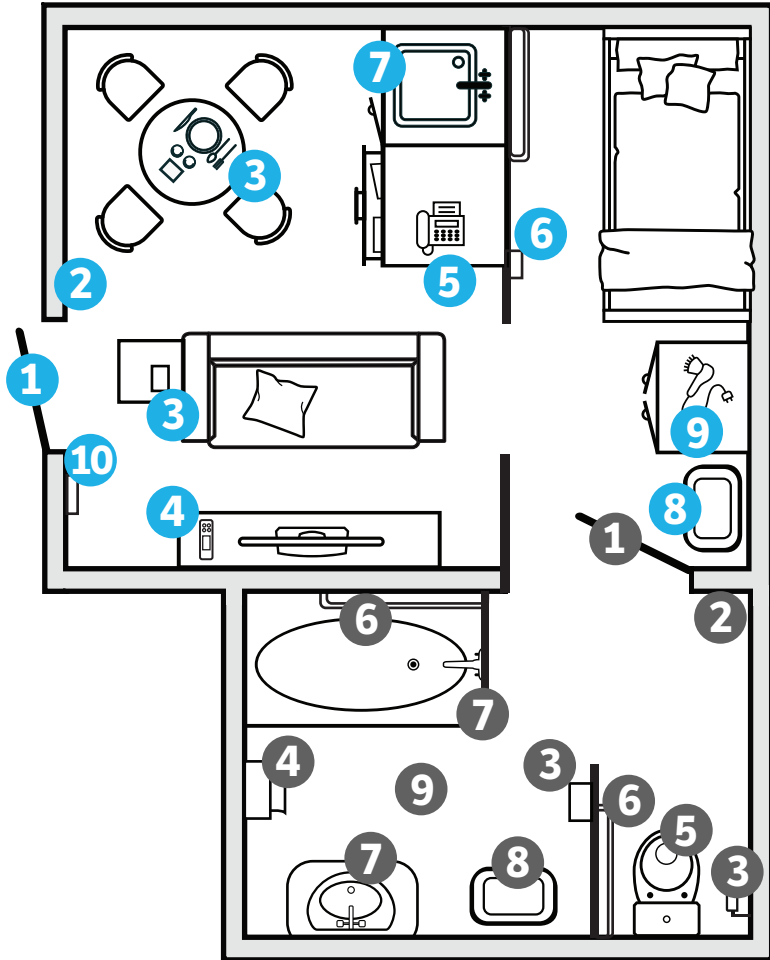

## Key Touchpoints for cleaning include:

### Resident Room

- 1 Door handle
- 2 Light switches
- 3 Furniture and handles  
(tables, chairs, dresser, nightstand, etc.)
- 4 TV remote
- 5 Telephone
- 6 Nurse call light
- 7 Faucet and sink
- 8 Trash/recycling receptacles
- 9 Any room items resident has added -  
alarm clock, hair dryer, cane, wheelchair arms, etc.
- 10 Thermostat

### Resident Bathroom

- 1 Door handles
- 2 Light switches
- 3 Dispensers (soap, toilet paper, etc.)
- 4 Paper towel holders
- 5 Toilet (handle, seat, etc.)
- 6 Handrails
- 7 Faucet/shower handle/sink/tub
- 8 Trash/recycling receptacle
- 9 Floors/walls

**Bright Solutions.**  
the smart way to clean!

find us at [mybrightsolutions.com](http://mybrightsolutions.com)

and on and